

Features

- Low profile space
- Ideal for automated placement
- Glass passivated chip junctions
- Low forward voltage drop
- Low leakage current
- High forward surge capability
- High temperature soldering



Mechanical Data

- SOD-323 molded plastic body over glass passivated chip
- Solder plated, solderable per JESD22-B102
- Laser band denotes cathode end

SOD323

Maximum Ratings & Thermal Characteristics (T_A = 25 °C unless otherwise noted)

Items	Symbol	1N4007WS	UNIT
Maximum repetitive peak reverse voltage	V _{RRM}	1000	V
Maximum RMS voltage	V _{RMS}	700	V
Maximum DC blocking voltage	V _{DC}	1000	V
Maximum average forward rectified current at T _L =90	I _{F(AV)}	1	A
Peak forward surge current 8.3 ms single half sine-wave superimposed on rated load	I _{FSM}	25	A
Thermal resistance from junction to lead ⁽¹⁾	R _{JL}	35	°C/ W
Operating junction range	T _J	–55 to +150	°C
storage temperature range	T _{STG}	–55 to +150	°C

Note 1: Mounted on PCB with 0.2 x 0.2" (5.0 x 5.0mm) copper pad areas.

Electrical Characteristics(T_A = 25 °C unless otherwise noted)

Items	Test conditions		Symbol	Min	Type	Max	UNIT
Instantaneous forward voltage	I _F =0.5A		V _F	-	0.92	-	V
	I _F =1A ⁽²⁾				0.98	1.1	
Reverse current	V _R =V _{DC}	T _A =25°C	I _R	-	-	5	uA
		T _A =125°C				50	

Note 2: Pulse test:300μs pulse width,1% duty cycle.

Fig.1 Forward Current Derating Curve

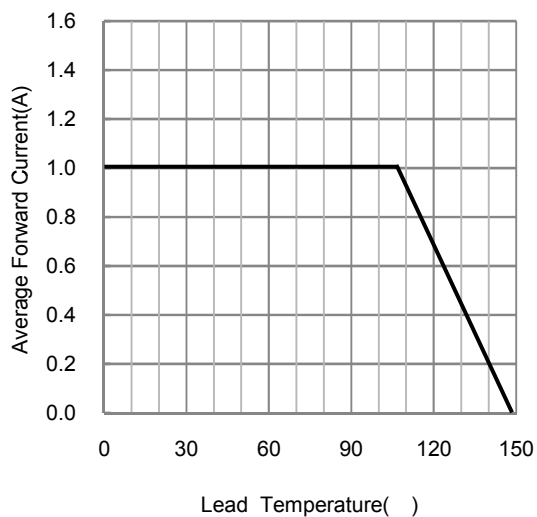

Fig.2 Maximum Non-Repetitive Peak Forward Surge Current

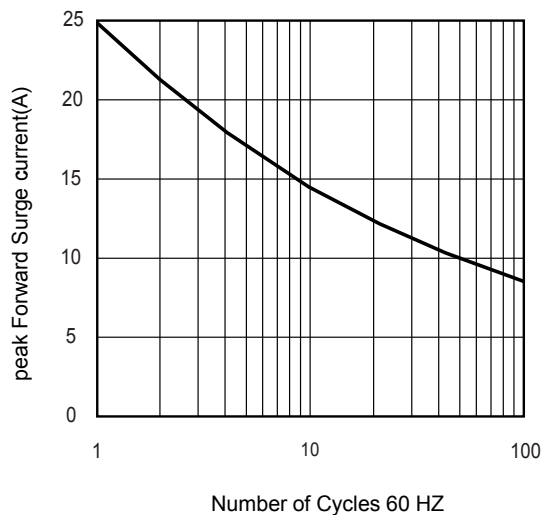

Fig.3 Typical Instantaneous Forward Characteristics

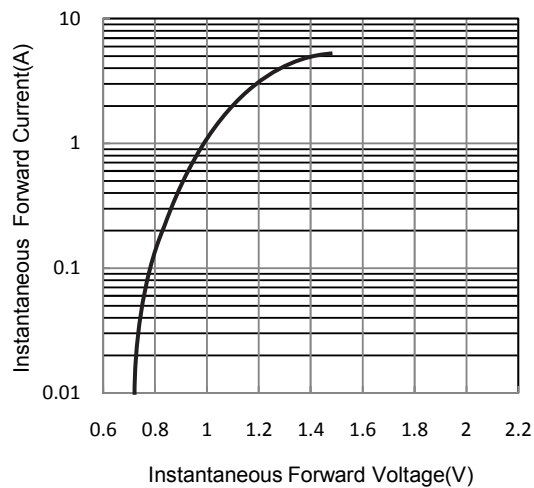
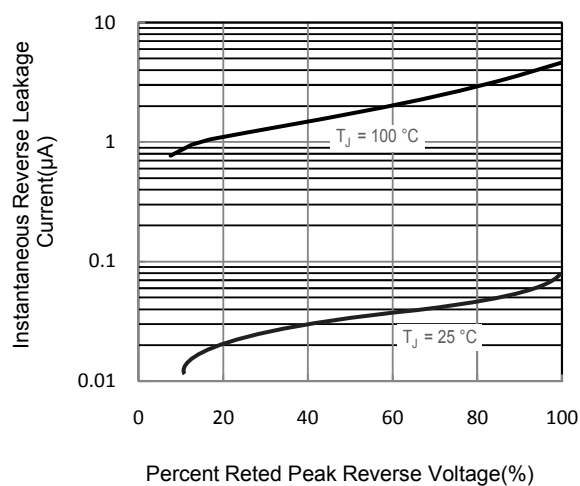
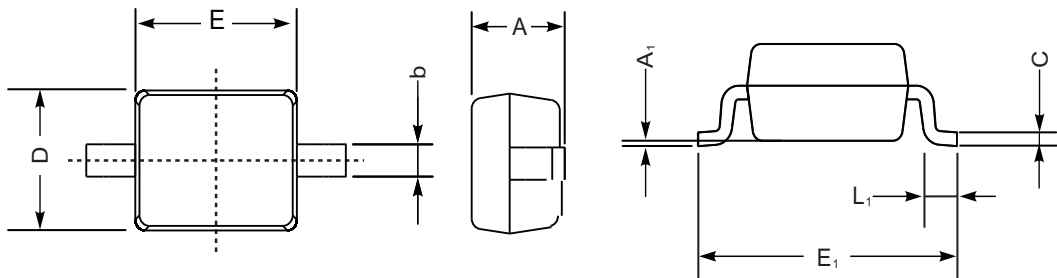

Fig.4 Typical Reverse Leakage Characteristics



SOD323



UNIT		A	C	D	E	E ₁	b	L ₁	A ₁
mm	max	1.1	0.15	1.4	1.8	2.75	0.4	0.45	0.2
	min	0.8	0.08	1.2	1.4	2.55	0.25	0.2	—
mil	max	43	5.9	55	70	108	16	16	8
	min	32	3.1	47	63	100	9.8	7.9	—

CCS Semiconductor and **CSemi** are trademarks of Semiconductor Components Industries, CCS Semiconductor reserves the right to make changes without further notice to any products herein. CCS Semiconductor makes no warranty, representation or guarantee regarding the suitability of its products for any particular purpose, nor does CCS Semiconductor assume any liability arising out of the application or use of any product or circuit, and specifically disclaims any and all liability, including without limitation special, consequential or incidental damages. CCS Semiconductor does not convey any license under its patent rights nor the rights of others.